

R L/240 LEAVENING PROVER



EXTERNAL CONSTRUCTION

- Isothermal insulating panels with 40mm polyurethane
- Structure in tubular aluminium pre-painted white
- Base in stainless steel AISI 304
- Assisted closure with piston system
- Handle integrated in the door for reduced dimensions
- Control Panel above door

INTERNAL CONSTRUCTION

- Chassis in stainless steel AISI 304
- Aluminium fan
- Suitable for euronorm trolleys type 40x60

FUNCTIONING

- Humidity with immersed resistance
- Heating with dedicated resistance
- Relative humidity between 30% and 95%
- Temperature up to + 45 ° C
- Electronically managed temperature and humidity

STANDARD EQUIPMENT

- Up to 8 leavening timers
- Alarm with acoustic signal for ready product
- Possibility of programmed ignition on a weekly basis
- Directionable Air Flow
- Electrical connection and water over the cell



MORETTI FORNI S.P.A.

www.morettiforni.com

e-mail: info@morettiforni.com

Via A.Meucci, 4 - 61037 Mondolfo (PU) ITALIA

Tel. +39.0721.96161 - Fax +39.0721.9616299

R L/240 LEAVENING PROVER

TOP VIEW

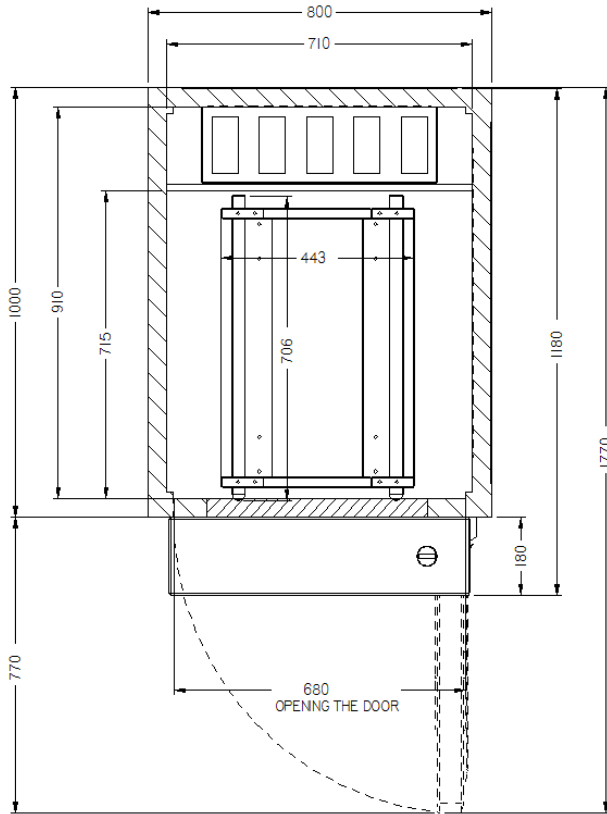

SIDE VIEW

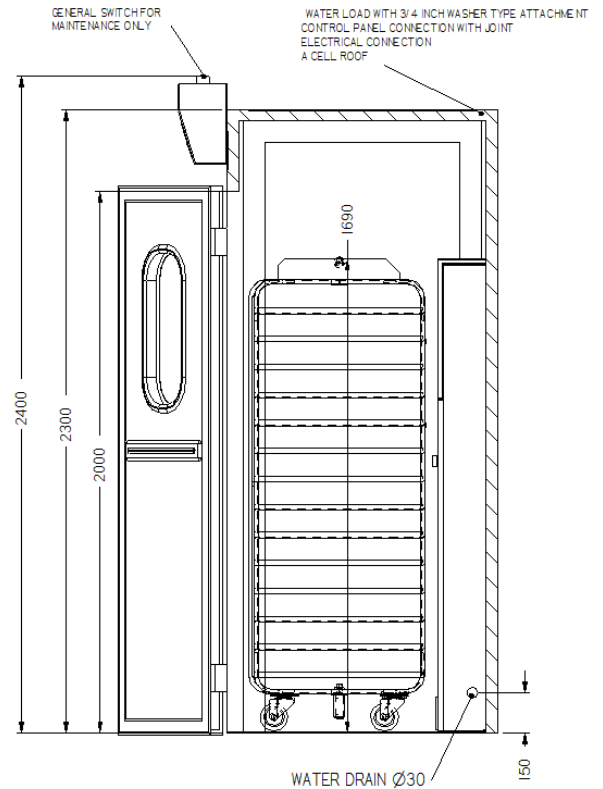

Note: The dimensions indicated in the views are in millimeters.

DIMENSIONS

External height	2400 mm
External depth	1180 mm
External width	800 mm
Weight	150 Kg

SHIPPING INFORMATION

Packed in wooden crate	
Height	2525 mm
Depth	1185 mm
Width	890 mm
Weight	(150+35) Kg

FEEDING AND POWER

<i>Standard feeding</i>	
A.C. V 400 3N 50/60Hz	
Max power	6 kW

* This value is subject to variation according to the way in which the equipment is used

- NOTE: MORETTI FORNI S.P.A. reserves the right to modify the characteristics of the products illustrated in this publication without prior notice